

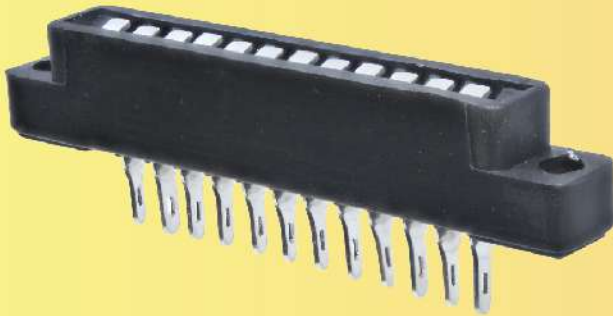

PRIME COMPONENTS

"Connections for life"

PCB CARD EDGE CONNECTOR PC -2B



PC 2B: SINGLE SIDED (PCX)

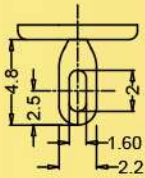

PC 2B(PCX)

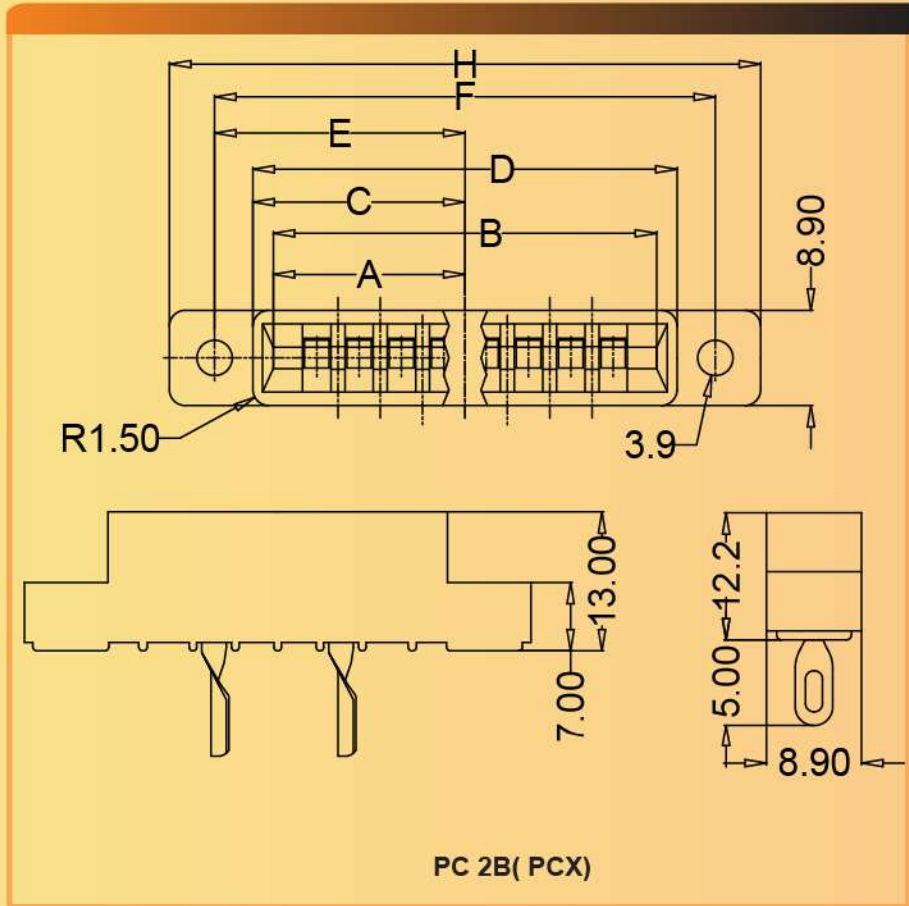

PC 2B(PCX)

TECHNICAL SPECIFICATION

Note: All Dimension are in mm

PARAMETERS	SERIES	PC 2B(PCX)
No of Contacts		12(PCx12)
Contact Type		Bifurcated Double Bellows (BBT)
Contact Terminal		Solder/PMT
Contact Pitch		3.96mm(0.156 inch)
Durability		500 Cycles
Insulator		PA66
Contacts		PB
Contacts Finish		Gold/Tin
Temperature Range		-40° C to +125°
Working Voltage		300Volts rms
Current Rating		5 Amps
Contact Resistance		10 miliohms (max)
Insulation Resistance		1000 Megaohms (min)
Voltage Proof		1000 Volts rms

Note : (1) Recommended PCB hole 1.40mm.

Series Also Includes...



PC 2



PC 3



PC 1



PC 2A

Off / Works : 830, GIDC Estate, Makarpura, Vadodara - 390010



www.primecomponents.net



+91-265-6642566/6670078, +91 9687676700



sales@primecomponents.net